



DuPont™ Corian® World

INSPIRATION FROM A SURFACE
THAT SEES A BEAUTIFUL FUTURE



corian.

DuPont™ Corian® World

INTRODUCTION	3
FOOD	5
WATER	17
CLADDING	27
FURNITURE	33
LIGHTING	37
SHOPFITTING	43
PUBLIC SPACES	47
HEALTHCARE	53
TRANSPORT	57
TECHNICAL SECTION	60
CONTACTS	82



Original thinking

Welcome to a world of ideas for working with DuPont™ Corian®...the ground-breaking surface that opens up new horizons for design. With its sophisticated combination of beauty, strength and versatility, Corian® can be applied to almost any conceivable scheme or sector, from interior to exterior and whether curved or angular, flat or textured, functional or decorative.

Corian® was invented by forward thinkers and designed for creative minds. The boundless possibilities for the material continue to be illuminated by new ideas, while many original installations still perform beautifully today.

Pure, solid and durable, Corian® is also malleable, repairable and endlessly adaptable, welcoming shape and customisation while offering a smooth, seamless dependability. DuPont invites your concepts and enquiries and we look forward to discovering how the material future may unfold.



An appetite for elegance

ENVIRONMENTS DEDICATED TO THE ENJOYMENT OF FOOD PRESENT PARTICULAR CHALLENGES. SENSES AND TASTES MUST BE ENTICED BY EFFORTLESS STYLE, WHILE FUNCTIONALITY CALLS FOR HYGIENE, RESISTANCE AND EASY-CARE UNDER CONSTANT USE

DuPont™ Corian® proposes the ultimate solution for meeting this combination of demands. Capable of creating fluent, monolithic installations with seamless beauty, its talents cater to multiple aspects of 'hospitality' design, whether in a private home or a premiere hotel. Integrity of performance together with the ability to transform to almost any design vision makes Corian® the enduring choice for everything from worksurfaces to dining tables, bar tops to serveries and, naturally, the sleekest of kitchen sinks.

Contemporary designs benefit from the pristine sophistication of DuPont™ Corian®.

Left: 012 kitchen by Magnabosco; design MK Design Lab; photo Magnabosco

Above: Radisson SAS hotel, Frankfurt; design John Seifert, Matteo Thun and Adam Tihany; photo DuPont™ Corian®



Working every angle

Redefining the rules for what a kitchen can be, Karim Rashid chooses multi-faceted DuPont™ Corian® to realise his distinctive vision.

Origami kitchen by Amr Helmy Designs; design Karim Rashid; photo Amr Helmy Designs



A team player

DuPont™ Corian® is aesthetically and functionally compatible with many other materials, working readily alongside steel, timber, glass, stone and more for a harmony that goes deep beneath the surface.

Left: Aprile kitchen by Boffi; design Piero Lissoni; photo Diego Alto

Above: Elektra kitchen by Ernestomeda; design Pietro Arosio; photo Ernestomeda



An inspiring outlook

While there's no doubt that first impressions count, the promise should never fade away into the background. The beauty of DuPont™ Corian® was built to last.

Kitchen in private apartment, New Zealand; design Mal Corboy; photo Mal Corboy Design Ltd



Through thick and thin

With DuPont™ Corian® the options for combining shapes, levels, downturns, edge details, materials and colours are limitless.

Designed to offer choice and adaptability, Corian® can be counted on to play any part within a scheme. In the hands of our expert fabricators, it can flow smoothly from breakfast bar to countertop, shelves to backlit display systems and so much more.

Kitchen in private apartment, New Zealand;
design Mal Corboy;
photo Mal Corboy Design Ltd



Service with hi-tech style

Right: This circular champagne bar features a chromatically changing light strip and is accompanied by seamlessly bicoloured cocktail tables also in DuPont™ Corian®. Fifth floor bar of Harvey Nichols, London; project by Shaun Clarkson ID; photo Jake Fitzjones

Above: An array of temptations at an M&S café beckons against a backdrop of easy-clean Corian®. Marks & Spencer in-store café, London; project Kiwi&Pom; photo Kiwi&Pom

Left: High concept dining at Inamo in London makes the most of durable Corian® table tops, which also serve as interactive and touch-sensitive projection screens. Inamo restaurant, London; project Blacksheep Architecture and Design; photo Francesca Yorke



Water worlds

FLOWING WITH OPPORTUNITIES TO CREATE BEAUTIFUL BATHROOM AND LEISURE DESIGNS,
DUPONT™ CORIAN® IS THE WISE CHOICE WHERE WATER IS THE ESSENTIAL ELEMENT

Smooth, silky to the touch and completely non-porous, Corian® will not warp, stain or promote the growth of mildew. Easily adapting to fluid shapes and integrated units, the material allows for a sensual experience of luxury combined with robust resistance and simplicity of care.

From egg-shaped baths to cylindrical basins and from one-piece vanity units to sleek wall cladding, there are few aspects of bathroom or spa design that cannot benefit from the lasting value of the material. A softly lustrous finish presents a subtle strength while the ability to add modified details enhances the versatility on offer.

Left: Tray vanity by Planit; design Emo Design; photo Planit

Above: Zone vanity by Planit; design Arter & Citton; photo Planit



Ahead of the curve

Shaping DuPont™ Corian® to your imagination is just one of the many satisfactions of designing (and living) with the material. Sympathetic to ambient temperature, invitingly velvet to the touch and flawless in its finish, Corian® can be as subtle or as striking as tastes demand, but is always confidently strong and sensually smooth. These statement pieces from Boffi maximise the unequalled allure of a material that was made to be enjoyed.

Left: Tevere bathtub by Boffi, design Claudio Silvestrin; photo Sabine Schweigert

Above: PHC washbasins by Boffi; design Piero Lissoni; photo Sabine Schweigert



On the level

Where there is a design dilemma, DuPont™ Corian® so often proposes an elegant and meaningful solution. Whether the challenge may lie in space or storage, form or content, fitting around plumbing or incorporating technology, integrated thinking applied to a highly workable material can resolve the issues in style.

Lab vanity by Makro; design Makro; photo Makro



Eureka moments

The revelation of working with DuPont™ Corian® comes in various forms: from the carefully created palette of exclusive colours (plus, of course, white, white and even more white) through to advanced fabrication technology and the dependable service that comes with years of investment in skill, innovation, ethics and sustainability.

Left: Hi-Line bathtub by Hafro; design Franco Bertoli; photo Hafro

Above: Comfort Tank Led bathtub by MOMADesign; design Ignazio Di Masi; photo MOMADesign



Clean lines

When seeking fresh inspiration, simplicity is so often the key. Less is absolutely more when all you need is the right material.

Enjoy shower tray and column by Blu Bleu; design Bullo Design Group; photo courtesy Blu Bleu



Facing the future

PUTTING TOGETHER ALL THE COMPLEX PIECES OF AN EXTERIOR CLADDING PROJECT
COMES EASILY TO ALL-WEATHER CORIAN®

With a beauty that is far greater than skin deep, DuPont™ Corian® has pushed the envelope of applications to now ‘wrap’ entire buildings. The virtues so ideally suited to interior surfaces also make Corian® superbly fit for purpose as a rainscreen façade, with the added benefit of excellent weatherability (plus proven UV resistance in a key collection of colours.)

Once you have explored the countless creative opportunities for specifying Corian® to the exterior of a structure, you can rest assured that these distinctive designs will endure. Resolute against stains, graffiti, temperature fluctuations, fire and time, Corian® is easy to return to pristine freshness with standard cleaning but can also be repaired should any untoward damage occur. Strong yet lightweight, its workability both on and off site can also optimise costs and time. Renewable and reusable, the sustained functionality of Corian® only adds to this value.

Left (and cover): A section of the sculptural curved façade made entirely from DuPont™ Corian® for the renovation of the Palais des Congrès, Ivoire Hotel, Abidjan, Ivory Coast; project by Pierre Fakhoury; photo DuPont™ Corian®
Above: A jigsaw of cladding sections in DuPont™ Corian® enhances the planes and angles of this bank in Demark. Broerup Sparekasse, Fredericia, Denmark; project by schmidt hammer lassen architects; photo Jens Nygaard



A lasting impression

Whether you choose to customise the material in any number of stand-out ways, or keep it pure and simple, DuPont™ Corian® makes a high-performance ventilated façade that will maintain its fresh and inviting finish for many years to come.

Private villa, Croatia; project by DVA Arhitekta; photo Marko Jukic



Modern methods

Compatible with a range of decorative techniques, fixing systems and complementary materials, DuPont™ Corian® offers an expansive vista of design and application possibilities for exterior use.

Above: The pavilion of Anansi playground in Utrecht, The Netherlands; project by Mulders vandenBerk Architecten; photo Roel Backaert
Right: "SML House", project by CEU Cardenal Herrera for "Solar Decathlon Europe 2010" award, Madrid, Spain; photo Borja Garcia



Furnishing the imagination

FROM THE MOST IMPRESSIVE OF STRUCTURAL INSTALLATIONS TO THE MOST REFINED OF ORNAMENTAL OBJECTS, CORIAN® WASTES NONE OF ITS POTENTIAL

It should come as little surprise that once designers discovered the numerous forms to which DuPont™ Corian® could be shaped and the practical tasks to which it could be applied, the material emerged from the best-dressed kitchens and into the wider world of creative potential. Fashions may come and go but timeless beauty and meaningful utility endures. Every aspect of DuPont™ Corian® along the value chain from colour development to manufacture to end-use is carefully considered and designed for life. Many of those now producing one-off pieces or accessory collections made with DuPont™ Corian® also use material that has been salvaged as part of the Zero Landfill goal that DuPont Building Innovations has achieved for its portfolio of high-performance products.

Technical solutions from thermoforming to CNC patterning and sublimation printing can tailor DuPont™ Corian® in ways that make it unique to each aesthetic sensibility, and while its sensuous touch and lustrous finish may belie its low-maintenance toughness, there is no doubting the genuine, long term pleasure of living Corian®.

Left: Snowflakes tables by Offecct; design Claesson, Koivisto, Rune; photo Offecct
Above: Vertigo Round trays by B&B Italia; design Naoto Fukasawa; photo B&B Italia



Designed for life

The wisdom of wipe-clean surfaces combined with artistic adaptability makes DuPont™ Corian® perfectly at home with the needs of furniture design.

Rodia table by Roche Bobois; design Daniel Rode; photo Michel Gibert



Enlightened philosophy

THE ETHEREAL TRANSLUCENCY OF CORIAN® CAN ILLUMINATE THE IMAGINATION

As consistently strong, solid and homogenous as DuPont™ Corian® is renowned to be, it also offers a delicate and diffuse relationship with the light. This quality can be explored either by selecting from certain colour choices or by creatively thinning sections of the material and backlighting to enchanting effect.

From free-standing lamps to expansive wall-cladding or commercial furniture installations, Corian® can be used for illuminated design either alone or in partnership with other materials and with smoothly integrated technology. An interplay of shadow and shape, translucent and opaque, colour and monochrome can be engaged by thoughtful combinations of material and space, light-source and reflection.

Left: Sparkling with inspiration, DuPont™ Corian® gives form to brilliant ideas. Cirrata lamp; design Markus Johansson; photo Markus Johansson

Above: This lamp collection exploits the spellbinding and pioneering translucency of the 'Illumination series' of colours for Corian®. Genotype lamps; design Tomek Rygalik; photo Filip Miller



Glowing prospects

DuPont™ Corian® conducts the energy of light with a gentle diffusion, settling into strong, solid shape while appearing as though still fluid or gossamer soft in nature. Capturing ephemeral beauty within lasting material form, Corian® enables an exciting array of lighting designs.

Above: Octopus by Rene Sulc for “The Fresh Light of Corian®” exhibition, Milan, April 2011; photo Leo Torri
Right: Hotel Sofitel Brussels Le Louise, Belgium, project by Antoine Pinto; photo Sofitel



Visionary practicality

When a major trade fair for the fashion industry understood the need for a permanent, coherent and enlightened solution to its modular display stands, DuPont™ Corian® was the answer. These luminous booths are made with Corian® in Ice White and, however arranged, will reflect well on a wise decision year after year.

Premiere Vision exhibition area, Paris, France; project by Eric Jourdan and Francesca Avossa; photo Felipe Ribon



Tailor made for retail design

LUXURY OR HIGH STREET, BOUTIQUE OR EMPORIUM, THE RIGHT SHOPFITTINGS SHOULD REPRESENT A DISTINCTIVE BRAND IDENTITY WHILE ALSO BEING READY TO SERVE

When it comes to fitting out retail environments, with Corian® it's never a hard sell. Apart from the ability to customise a project to embody the philosophy of both architect and client, Corian® can withstand the demands of high-traffic commerce with confident grace. Furthermore the material is renewable to full beauty should any wear and tear become excessive. Add to that an original collection of timeless colours (custom colours are also possible) and the multiple options for bespoke detailing, and there's little that Corian® can't offer to retail design.

Whether as display systems, cashiers desks, robust ornamentation, fitting room furniture, even doors, drawers and decorative shop fronts, the material can serve whatever purpose is asked of it - and with DuPont™ Corian® the long term experience of the brand remains a vital investment in customer satisfaction.

Left: DuPont™ Corian® presents a warm welcome at this underground retail emporium. Backlit desks, Pink fashion store, Klagenfurt, Austria; project by Inform; photo tinefoto for Inform
Above: The Manolo Blahnik boutique in Moscow features customised DuPont™ Corian® panels that pay homage to the traditional patterns of Russian lace. Decorative wall panels, Manolo Blahnik store, Moscow, Russia; project Data Nature Associates; photo Data Nature Associates



Style with substance

DuPont™ Corian® not only enables the expression of distinctive character, but also allows unique merchandise to speak for itself. Working wisely alongside other materials within a structure, it partners the product offering with conviction.

Left & Above: Store façade, Sportalm fashion store, Wien, Austria; project Baar-Baarenfels Architekten; photo Baar-Baarenfels Architekten

Right: Display desk at Acne-Store, Berlin, Germany; project Pierre Jorge Gonzalez/Judith Haase/Atelier Architecture & Scenography; photo Pierre Jorge Gonzalez/Judith Haase/Atelier Architecture & Scenography





Public service

THE SUSTAINED DURABILITY OF CORIAN® MAKES IT A SMART CHOICE FOR MULTI-USER SPACES

While it's important that projects for public or high-traffic use think long term about the quality, performance and maintenance of the chosen materials, these spaces should also be pleasing, uplifting and inspiring. DuPont™ Corian® gets to work on solving these challenges with dynamic dependability.

Around the world, museums, galleries, educational buildings, lobbies, leisure facilities, airports and even subway stations have employed the material's potential with installations that span from the artistic to the utilitarian. Able to address all the key issues from optimising space, multi-user demand and maximising budgets to realising the most exotic of design ideas, Corian® has been working diligently in the public eye for many years.

Whether supporting ideas or weary bodies, DuPont™ Corian® serves with faithful poise.

Left: Shelving solution, Christie's headquarters, Milan, Italy; project by AquiliAlberg; photo Francesco Brigida

Above: Lounge area, SberBank of Russia, Almaty, Kazakhstan; project by Valent LLP; photo Art Strike Asia

Artful intelligence

Michael Craig-Martin etches his 'One World' vision for the atrium of the European Investment Bank in Luxembourg with sweeping lines of colourfully inlaid DuPont™ Corian®, creating an artwork will be an asset for the long term.

Floor decorations, Banque Européenne d'Investissement (BEI), Luxembourg; project by Michael Craig-Martin; photo Christian Mosar





An appeal to the senses

Sinuous shapes and inspired detailing in DuPont™ Corian® make for high-impact lobby spaces, while ensuring a sense of calm continuity.

Above: Reception desk, Tullow Oil headquarters, London, UK; design Peldon Rose; photo Peldon Rose
Right: Lobby-For-The-Time-Being installation, The Bronx Museum of the Arts, New York; project by Adam Jakubowski and Bradley Rothenberg of Acconci Studio; photo Bradley Rothenberg

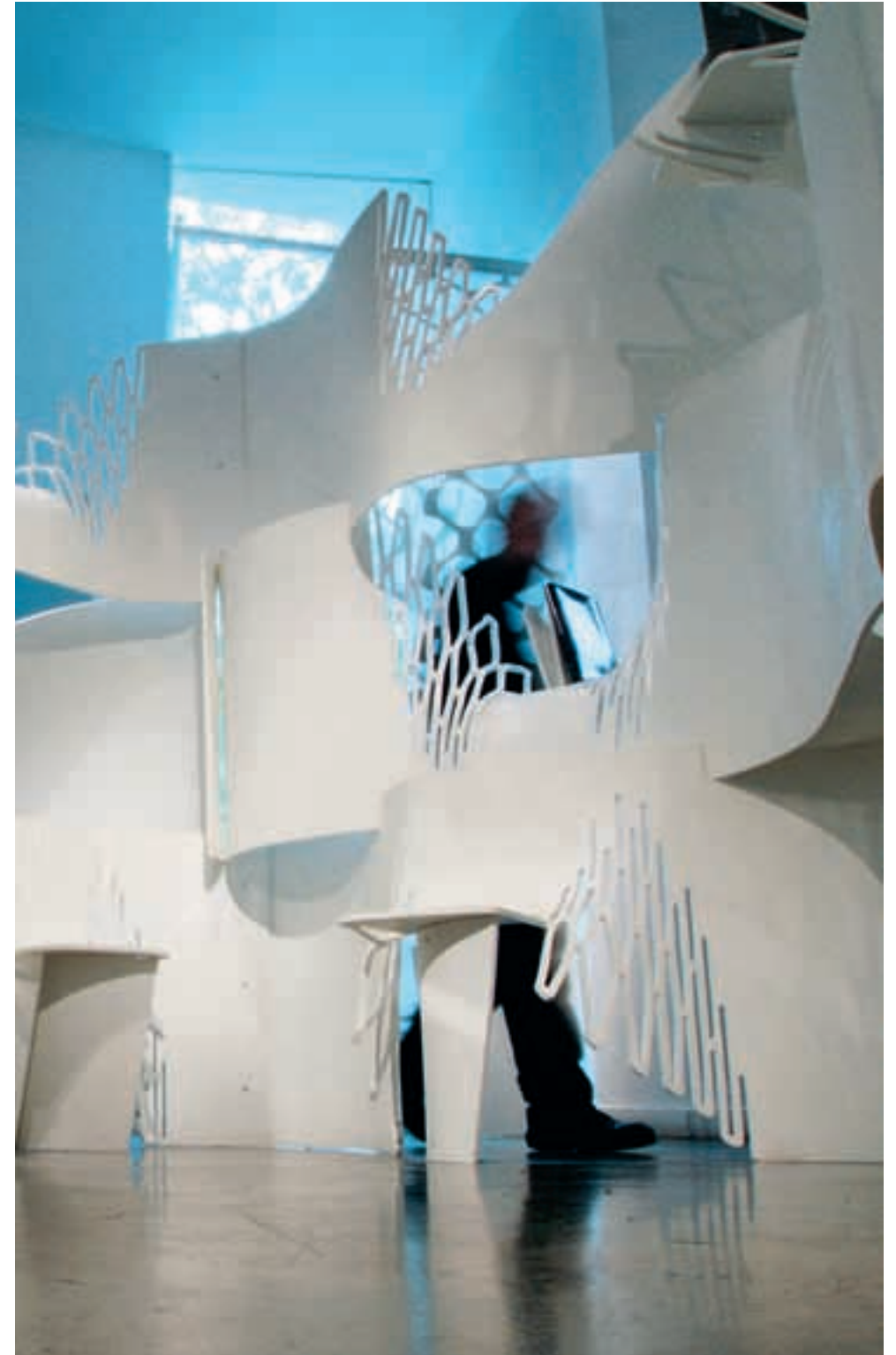



Slick, pristine, solidly resistant to harbouring infectious agents and seamlessly cleanable, DuPont™ Corian® offers a proven performance that helps to build trust in modern healthcare facilities.
Nephrology centre, Saint Denis, France; project by architect Jean-Baptiste Bouilloc; photo Ecliptique - Laurent Thion



The right prescription for healthcare

HYGIENE-CRITICAL ENVIRONMENTS DEMAND THE OPTIMUM COMBINATION OF RESISTANCE, AESTHETICS AND VERSATILITY. DUPONT™ CORIAN® PRESENTS THE SENSIBLE SOLUTION FOR A BROAD SCOPE OF HEALTHCARE DESIGNS

Hospitals, laboratories and dental facilities internationally have benefitted from the invaluable combination of certified performance, sustainability and elegance that Corian® offers. Whether as completely non-porous and functionally seamless workbench installations, user-friendly curves, or a comforting mural in a children's ward, Corian® enhances both design ingenuity and peace of mind. Clinicians and architects alike have understood how the sensory appeal of the material together with its contribution to preventing cross-infection and its trustworthy response to appropriate cleaning makes DuPont™ Corian® the perfect partner for a wide range of applications. And while pristine white is the obvious choice for key operational surfaces, there's no reason why design schemes for reception areas, patient accommodation, therapy facilities and consulting rooms should not take full advantage of the extensive and encouraging colour choice on offer.

Above: The ability to create unique aesthetic effects alongside proven reliability, gives Corian® the edge when it comes to designs that are both imaginative and responsible. Pediatrics and pediatric emergency reception area, Hospital Universitari Sant Joan de Reus, Spain; design by FernandezCoca.com; photo curArte



Smooth operator

A study in hygienic fidelity, DuPont™ Corian® is utterly non-porous with a sleek homogeneity that also allows for streamlined design.

Above: Workdesks, Hearing Pathology Institute, Kajetany, Poland; photo CCI



Teaching and research facilities, treatment rooms, operating theatres and scrub rooms can all take advantage of the multiple possibilities for applying DuPont™ Corian® to critical surfaces.

Left: Dr. Benguigui dentist studio, Neuilly Sur Seine, France; design Luc Boulais; photo Jean-Christophe Galmiche
Above: Oncology Centre, Bydgoszcz, Poland; photo CCI



The journey of ideas

THE UNIQUE CHALLENGES PRESENTED BY TRANSPORT DESIGN, WHETHER AFLOAT,
AIRBORNE, MOBILE OR STATIONARY, ARE ADMIRABLY ADDRESSED BY
THE CAN-DO ATTITUDE OF CORIAN®

Compact spaces, awkward shapes, spill-proof ergonomics, climate and pressure conditions, flexural strength and seamless glamour...all considerations for transport projects demanding a material that can go the distance. Designs from mega yachts to cruise liners, motor homes to commuter trains, private jets to passenger planes - plus the ports, stations and facilities that serve them - have all enhanced the experience of travel by trusting in DuPont™ Corian®. The need for a tough yet lightweight material that can adapt to almost any creative vision is set to go only from strength to strength. Even the sky presents no limit - perhaps soon Corian® will join a number of other innovative DuPont materials already contributing to advanced space flight? Sophisticated in performance, technology and aesthetics, there's no doubt Corian® is headed for an exciting future.

Left: Interiors of Comet 52 by Comar Yachts; project by Studio Vallicelli; photo Comar Yachts
Above: Interiors of yacht by Holland Yachting Group; photo Holland Yachting Group



Where next?

Skilled fabrication, optimum adaptability, enduring performance and sheer beauty make DuPont™ Corian® the right fit for the most demanding design projects, wherever your imagination may take you.

The black Light Cycle from “TRON: Legacy” movie, made in DuPont™ Corian® by Altha® for “TRON designs CORIAN®” exhibition (organized by DuPont™ Corian® under license of Disney at 2011 Milan week of design); photo Leo Torri for DuPont™ Corian®

What is DuPont™ Corian®?

DUPONT™ CORIAN® IS A SOLID, NON-POROUS, HOMOGENEOUS SURFACING MATERIAL COMPOSED OF ± 1/3 ACRYLIC RESIN (ALSO KNOWN AS POLYMETHYL METHACRYLATE OR PMMA) AND ± 2/3 NATURAL MINERALS. THE MAIN MINERAL IS ALUMINIUM TRIHYDRATE(ATH) DERIVED FROM BAUXITE, AN ORE FROM WHICH ALUMINIUM IS PRODUCED. FOR MORE INFORMATION ON THE COMPOSITION OF THE MATERIAL, PLEASE CONSULT THE CORIAN® MATERIAL SAFETY DATA SHEETS (MSDS) AVAILABLE AT [HTTP://MSDS.DUPONT.COM](http://MSDS.DUPONT.COM) OR FROM YOUR LOCAL SUPPLIER

KEY CHARACTERISTICS

RESISTANT

Since its introduction in 1967, Corian® has proved itself to be a remarkably durable material that is easy to live with. It cannot delaminate and stands up well to daily wear and tear. It resists most of the impacts, nicks and cuts that occur in heavy traffic areas. Corian® has been tested for its mechanical, thermal, electrical and other surface properties. Results of these specific tests as well as details on the other physical properties of Corian® can be consulted on page 71 in the “PERFORMANCE PROPERTIES” section of this book.

HYGIENIC

Corian® is a non-porous material. It is solid through its entire thickness and can be fabricated with inconspicuous seams, rendering its surface hygienic. Corian® surfaces do not support the growth of bacteria or fungi. Corian® has been certified by an independent laboratory as a hygienic material according to the international norm DIN EN ISO 846.

REPAIRABLE

Surfaces in Corian® are renewable, meaning they can be fully restored with ordinary mild abrasive cleansers and a scouring pad. Cigarette burns, for example, can be easily removed in this way. Damage caused by abuse can usually be repaired on site without having to completely replace the material.

NON -TOXIC

Corian® is an inert and non-toxic material. Under normal temperature conditions, it does not emit gases. When burned, it releases mainly Carbon Oxides and the smoke generated is optically light and does not contain toxic halogenated gases. Because of these properties, Corian® is used in public areas and for sensitive applications such as airport check-in counters, walls and work surfaces in hospitals and hotels.

VERSATILE

The applications for DuPont™ Corian® are limited only by your own imagination. Pieces of Corian® can be glued together inconspicuously to create a seamless look, giving virtually unlimited design possibilities for surfaces. Long counters, for example, can be easily made in pieces in a workshop and then joined together at the installation site. Edges can be built up to look thicker.

THERMOFORMABLE

Corian® can be thermoformed in wooden or metal moulds at controlled temperatures in order to create various 2D and 3D design objects. Embossing effects can also be created using the Bas Relief technique.

TRANSLUCENT

The translucency of Corian® is especially striking in the lighter colours as well as with thinner sheets. Many designers are now using the material to create lamps or lighting effects in various applications. The new colour family, called the Illumination Series, consists of 5 colours in 6 mm and 12 mm sheets featuring enhanced translucency to be used for creating special lighting effects.

WORKABLE LIKE WOOD

Corian® can be worked like hardwood and using similar tools. Most Corian® fabricators originally trained as carpenters.

ENVIRONMENTALLY FRIENDLY

Corian® is manufactured in compliance with strict standards in order to limit waste and energy consumption at all stages of the production process. Both the material itself and the adhesives used to install it are GREEN GUARD Indoor Air Quality Certified® as producing low VOC emissions.

Production

DUPONT™ CORIAN® IS MANUFACTURED BY DUPONT AS SHEETS AND PRE-FORMED SHAPES IN THREE PLANTS LOCATED IN THE USA, JAPAN AND KOREA. CORIAN® SHEETS ARE PRODUCED ON CONTINUOUS CASTING LINES AND CORIAN® SHAPES ARE PRODUCED THROUGH POLYMERIZATION INSIDE METAL MOULDS USING A CONTINUOUS MANUFACTURING PROCESS

STANDARD PRODUCTS

DUPONT™ CORIAN® SHEETS

Available in various standard thicknesses, easily cut to size by professional fabricators. All colours in the standard colour palette are available in 12 x 760 x 3658 mm sheets. A limited number of colours are also available in other dimensions: thickness 4-6-19 mm and width 930-1300-1500 mm. Check with your supplier for the latest product offering.

FR COLOURS (EN 13501-1)

Sheets can also be supplied in an FR grade, which is more resistant to fire for applications in public areas and for cladding projects, according to norm EN 13501-1, classified as B - s1, d0. Regular Corian® colours are classified as C - s1, d0.

SHEET OPTIMISATION

The final cost of Corian® fabricated products may be influenced by material wastage. In order to reduce costs, DuPont suggests that sheet optimisation be taken into consideration during the design process.

DUPONT™ CORIAN® JOINT ADHESIVE

Corian® joint adhesive is available in a range of specific colours to co-ordinate with Corian® sheets and shapes. In order for the DuPont 10-Year Limited Installed Warranty to apply, all Corian® seams must be bonded with Corian® joint adhesive.

Right: "Thalweg" decorative panel by Marotte; design and photo Marotte

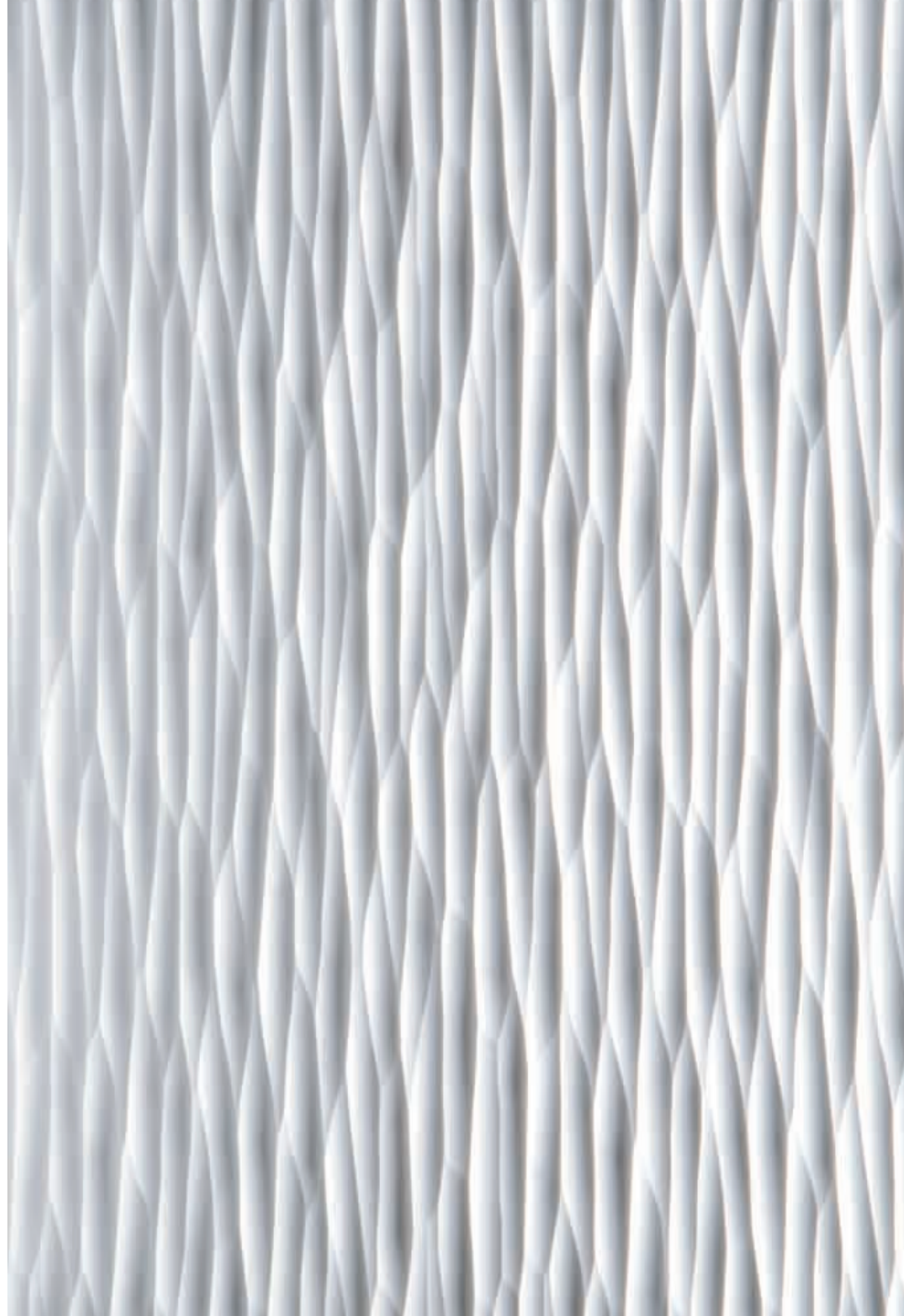



DuPont™ Corian® Shapes Standard and Customised options

A WIDE RANGE OF STANDARD CORIAN® SINKS AND BOWLS CREATED USING CAST MOULDING TECHNOLOGY IS AVAILABLE IN 4 SOLID COLOURS FOR CUSTOM INTEGRATION WITH CORIAN® SHEETS IN ORDER TO CREATE A SINGLE, CONTINUOUS SURFACE

STANDARD SHAPES

The range includes vanity basins for bathrooms, single and double sinks for kitchens, bars, small wash-up areas, hospitals and laboratories. The seamless integration of DuPont™ Corian® shapes into countertops means that there are no rims or ridges that might trap dirt or moisture, minimising cleaning and maintenance and providing improved hygiene. Care, maintenance and installation instructions are provided. Appropriate accessory products, including installation hardware, are also available for residential kitchens.

CUSTOM SHAPES

Fabricated sinks and bowls in different shapes and dimensions which are created by thermoforming and bonding together pieces of Corian® are available in all colours of the palette. A number of independent companies manufacture and distribute these shapes through the Quality Network. This enables architects and designers to achieve particular aesthetic effects, such as unbroken colour continuity for an entire work surface. Thermoformed shapes made with Corian® and shapes resulting from an additional production process with the Corian® sheet are not covered by the DuPont Warranty.

Thanks to their extensive experience in Corian® fabrication, most Quality Network fabricators can make practically any shape specified by designers by thermoforming and joining together pieces of Corian®. (These custom shapes, however, are not covered by the DuPont Warranty). For the full range of shapes, please contact the DuPont office in your region, the details of which are in the contact section.

A helpful choice of fifteen ready-moulded sinks and four bowls are available in four colours and a variety of sizes, shapes and possibilities for smooth, seamless and hygienic integration into countertops made from Corian®.

The model 969 sink offers outer dimensions of 381 mm x 451 mm with an inner depth 175 mm, with 'square' radius corners. A range of shapes with softer, curving corners is also available. Photo Leo Torri for Corian®



The capacious 966 model 'Butler' style sink measures 750 mm x 451 mm with an inner depth of 176 mm.
Photo Leo Torri for DuPont™ Corian®



The 970, at 581 mm x 451 mm by 175 mm is shown here in Glacier White, with three further solid shades available for all standard models. Photo Leo Torri for DuPont™ Corian®



To maximise convenience, standard sinks are available in a variety of sizes and shapes. The elegantly square 965 measures 451 mm x 451 mm. Photo Leo Torri for DuPont™ Corian®



The compact 967 model, at 211 mm x 401 mm x 140 mm, can serve as a single small wash-up sink or sit alongside a larger model for optimum functionality. Photo Leo Torri for DuPont™ Corian®

HOW TO SPECIFY DUPONT™ CORIAN®

Five points to remember when specifying Corian®:

1. Specify product manufacturer: Corian® is made only by DuPont.
2. Specify nominal thickness: 12 mm for horizontal applications or 6 mm for vertical applications. For special thicknesses, please contact your Corian® representative.
3. Specify exact colour(s) by name. Please visit our website at www.corian.com
4. Specify code references and colours: be sure to specify the exact code references and the colours of bowls and sinks (e.g. 810 S cameo white). Please visit our web site at www.corian.com
5. Specify fabrication and installation: to ensure that the fabrication and installation of your job meet the requirements for the DuPont 10-Year Limited Installed Warranty, specify that the work must be carried out by a DuPont Authorised Quality Network fabricator.



Above: "Zenwave" decorative panel by Marotte; design and photo Marotte

PERFORMANCE PROPERTIES OF DUPONT™ CORIAN® PRODUCTS

PROPERTY	TEST METHOD	TYPICAL RESULTS		UNITS	*
		6 mm sheet	12 mm sheet		
Density	DIN ISO 1183	1.73 – 1.76	1.68 – 1.75	g/cm ³	1
Flexural modulus	DIN EN ISO 178	8920 – 9770	8040 – 9220	MPa	1
Flexural strength	DIN EN ISO 178	49.1 – 76.4	57.1 – 74.0	MPa	1
Elongation at break	DIN EN ISO 178	0.58 – 0.94	0.76 – 0.93	%	1
Compressive strength	EN ISO 604	178 – 179	175 – 178	MPa	1
Impact resistance (spring load)	DIN ISO 4586 T11	> 25	> 25	N	1
Impact resistance (ball drop)	DIN ISO 4586 T12	> 120	> 120	cm	1
Surface hardness (Mohs index)	DIN EN 101	2-3	2-3		1
Resistance to surface wear	DIN ISO 4586 T6	63 – 75	58 – 63	Lost weight mm ³ /100 rev.	1
Resistance to boiling water-increase in weight	DIN ISO 4586 T7	0.1 – 0.7	0.1 – 0.3	%	1
Resistance to boiling water-surface change	DIN ISO 4586 T7	No visible change	No visible change		1
Dimensional stability at 20°C	DIN ISO 4586 T10	< 0.16	< 0.16	% change in length	1
Resistance to dry heat-180°C	DIN ISO 4586 T8	4-5 slight change	4-5 slight change		1
Lightfastness (Xenon arc)	DIN ISO 4586 T16	> 6	> 6	Blue wool scale	1
Resistance to bacteria and fungi	DIN EN ISO 846	Does not support microbial growth			3
Electrostatic surface behaviour	DIN IEC 61 340-4-1		> 1 x 10 ¹²	Ω	4
Calorific potential	NF EN ISO 1716		9.15	KJ/g	5
Smoke index	NFF 16-101	Class Fo	Class Fo		6
Reaction to fire (Corian®)	EN 13501-1:2003	Euroclass C-s1, do	Euroclass C-s1, do		8a
Reaction to fire (Corian® FR and custom)	EN 13501-1:2003	Euroclass B-s1, do	Euroclass B-s1, do		8b
Flammability test (Corian® FR)	DIN 4102-1		Class B1		9
Fire tests (Corian® FR)	BS 476 part 6 & 7		Class o		10
Fire testing - railroad vehicle	DIN 54837		S4, SR 2, ST 2		11
Smoke toxicity	DIN EN ISO 5659-2		Pass		12

- (1) test report Q IWQ MBL 733 1785-1 (for classification according to DIN EN 438 part 1 & 7) from LGA –Germany/04-2004
 (3) test report 5642219 from LGA-Germany 03/2004
 (4) test report EMA-SMG-814 1131 IWQ-MBL 734 1109 from LGA-Germany/03-2004
 (5) test report 11624-04 from SME/SNPE-France/03-2004
 (6) classification reports 11631-04 & 12260-05 from SME/SNPE-France/03-2004 & 05-2005
 (8a) classification report 185122 from Warringtonfiregent 07/2009
 (8b) classification report 15279E from Warringtonfiregent 12/2011
 (9) test report 230005623 from MPA NRW-Germany/2006
 (10) test reports 154054 & 154053 from Warringtonfire-UK/06-2006
 (11) test report P60-08-0018 (classification according to DIN 5510-2) from RST-Germany/01-2008
 (12) test panel P60-08-3107 from RST-Germany/02-2008.

Fabrication & Finishing

THE PROCESS BELOW ILLUSTRATES HOW DUPONT™ CORIAN® CAN BE TRANSFORMED FROM SHEETS INTO, FOR EXAMPLE, AN INNOVATIVE SPEAKER MOUNTING SYSTEM. IT CAN BE CLEARLY SEEN HERE THAT CREATING WITH CORIAN® IS AN EXERCISE OF BOTH CRAFTSMANSHIP AND INNOVATION

BASIC FABRICATION TECHNIQUES

DuPont™ Corian® is a material which combines the durability of stone with the workability of hardwood. It is impossible to cover all fabrication techniques in this book, but the following sections describe the most important elements.

CUTTING

Corian® is harder than wood. In order to cut a full sheet to obtain the desired pieces, saws and routers must be powerful enough to work the material properly. Straight cuts are made with a circular saw with carbide-tipped or diamond-tipped teeth. Curved cuts are made with manual routers or with numerically controlled routers (CNC), depending on the number of identical pieces that need to be cut. Rounded inside corners are routed in order to prevent cracking. Router bits must have tungsten carbide tips.



SEAMING

All the edges of the pieces to be joined must be straight, square and thoroughly cleaned using ethanol on a clean white cloth before applying adhesive. Two-component Corian® joint adhesive in the appropriate matching colour should be used to obtain inconspicuous seams - one of the key features of Corian®.



SANDING

Surfaces are sanded with a random orbital sander following the “North-South, East-West” direction using small circular motions. Sanding is to be done in several steps from rough to fine grades of sandpaper. The finish can be varied from matt to high-gloss, depending on the effect the designer wishes to obtain. DuPont suggests a semi-matt finish, which is the easiest finish to obtain and maintain. High-gloss finishes tend to dull over time, especially in areas which see intense use.



ADVANCED FABRICATION TECHNIQUES

THERMOFORMING

DuPont™ Corian® can be thermoformed using plywood or metal moulds at temperatures of approximately 160°C. Corian® may be formed up to an internal radius starting at 25 mm with two dimensional thermoforming, depending on the thickness and the colour of the sheet. Even cooling in the mould will prevent residual stresses and provide superior results. Thermoformability differs depending on the saturation or particle loads in the sheet.



INLAYS

Inlaying Corian® with different materials or with different colours of Corian® can enhance the inherent beauty of the material. Various inlay materials are compatible with Corian®. DuPont suggests avoiding large inlays containing metals because of their high thermal expansion coefficients. Logos can be easily created using inlays in Corian®.



SUBLIMATION

Known as “image transfer by sublimation”, this technique allows designers to personalise Corian® in a completely new way. The sublimation process consists of transferring images into a sheet of Corian® so that - almost like a human tattoo - a permanent image is created within the surface. The printed Corian® can then be re-polished and thermoformed in the same way as unprinted Corian®. Image transfer by sublimation is a new tool for communication and for enhancing creative expression by designers, engineers and architects.



TRANSLUCENCY

Translucent effects can be obtained via the use of translucent colours or by reducing the thickness of standard DuPont™ Corian® colours.

THE ILLUMINATION SERIES

The colour effects from these materials change dramatically when backlit. When the lighting system behind your design is turned on, the pastel appearance disappears and the appearance is dominated by the aesthetics of the light source. Be creative! Test each one of these with different types of light sources to see the many variations and shades of white light and the effects using coloured light. You will be amazed by the possibilities!

TRANSLUCENCY BY REDUCING THICKNESS

In certain colours and thicknesses, Corian® reveals its full radiance and depth when it is exposed to light. This quality lends Corian® not only to the creation of atmospheric room lighting, but also to sensuously-shaped lamps, dramatically illuminated furniture, and screens which reveal an intricately-carved pattern when backlit.

In particular, lighter and solid colours are the best for use in this kind of application. These kinds of effects can be obtained by locally reducing the material's thickness via routing or engraving. For greater light transmission, Corian® can be reduced to a thickness of 2-3 mm to allow more light to pass through. When a specific point of light is required, an integrated LED light source positioned in the back of a hole is a good option. This type of set-up is often used to create a logo or signage. To obtain a more diffuse effect, the light source is generally installed at a distance (typically 15 cm) from the back of the panel. The routing can be done with a CNC machine in any kind of pattern or design. Playing with varied depths of the routed pattern and creating a 3D relief gives the possibility to create an effect reminiscent of a painting.



From top to bottom: Residential vanity solution; photo TC Studios - Backlit wall feature in Corian®, residential bathroom solution; photo Corian® - Kitchen top, "Z. Island by Corian®", design Zaha Hadid, 2006 Milan week of design; photo Leo Torri for Corian® - CNC carved and backlit wall panel in Corian® by Michael Young for 100% Design; photo Jake Fitzjones

TEXTURE (CNC/BAS-RELIEF)

DuPont™ Corian® makes it possible to obtain innovative three dimensional effects, which gives a new perspective to architectural design and home decoration.

Creating a 3D texture on Corian® can be done through CNC routing or via bas-relief. With the bas-relief technique, the Corian® panel is heated to 160°C and then pressed on a "stamp" with the required pattern.

SAND BLASTING

Just like wood, glass and other materials, Corian® can be sandblasted with different mediums. Playing with the roughness and depth of the blasting can create numerous effects. This technique can be used for signage and wall cladding, or to add dramatic accents to a design piece.

BASIC GUIDELINES FOR DESIGNING WITH DUPONT™ CORIAN®

Perimeter supports are used on the underside of a Corian® countertop to avoid warping and cracking. The perimeter support strips should be made in moisture-resistant MDF or moisture-resistant plywood. Corian® countertops are bonded to the support strips using flexible silicone adhesive. Never screw directly into Corian®. All Internal corners should be radiussed.

The required method for installing square hobs is the high-strength cut-out. This technique has been patented by DuPont and it is the best and most effective way to avoid cracking around hobs. Flush-mounted hob units integrated into a Corian® countertop are covered by the DuPont 10-Year Limited Installed Warranty, provided that the recommended fabrication and installation guidelines have been followed. These guidelines are included in the Corian® fabrication manual, and Quality Network Corian® fabricators have the necessary knowledge to install any type of hob.

THERMAL EXPANSION

The thermal expansion of Corian® is approximately 1 mm per meter with a temperature change of 30°C. Always leave a gap of at least 1.5 mm to allow satisfactory caulk penetration.

Specific Applications

VERTICAL SURFACES

INTERIOR WALL CLADDING

Ideal supports for DuPont™ Corian® are:

- Water-resistant gypsum board
- Moisture-resistant plywood
- Moisture-resistant MDF
- Any sound tile surface
- Plasterboard sheeting
- Master board

When covering old tiles, remove all loose and broken tiles. All tiles must be cleaned with clear denatured alcohol prior to fixing Corian® to the surface.

The installation must allow for expansion and contraction, and as a result flexible adhesives should be used.

There are two types of seams for vertical applications:

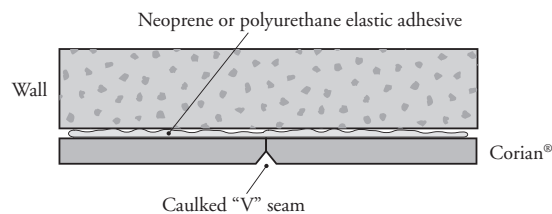

1. Caulked "V" seam

The caulked "V" seam uses colour-matched silicone sealant. The face edges are chamfered to form a small "V".

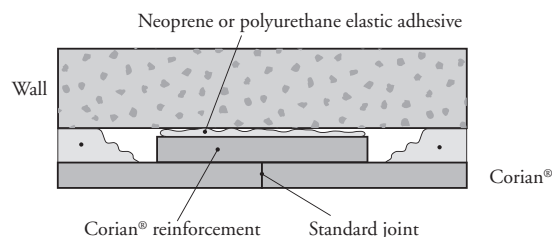

2. Inconspicuous Corian® joint adhesive seam

The standard Corian® joint adhesive seam can be used on large surfaces to create large one-piece sections.

EXTERIOR WALL CLADDING

The design versatility and performance features of DuPont™ Corian® - the availability of different colours and aesthetics, custom colours, textures and finishes, the ability to shape and form the material, and its exceptional durability and renewability - have led a number of architects and designers to use Corian® for exterior applications. These have included street signage and benches, bus stop canopies and shop façades, and more recently even façade cladding. To satisfy this growing interest, DuPont has developed a testing program to evaluate the potential of Corian® for exterior applications. Please contact the local DuPont office for all your questions regarding commercial or residential building façades.

In general, Corian® offers good resistance to UV rays, but certain colours perform better than others in terms of weather resistance and fading. While the physical properties of Corian® are not adversely affected by outdoor exposure, surface gloss can be reduced.

Contrast between veining and background colour may be reduced and slight background colour changes may be observed over time. These changes can be removed by periodic sanding, but this refurbishing step is not always practical, such as in cases where Corian® is used for covering large architectural surfaces like building façades. The table on the next page shows which colours are most suitable for exterior cladding.

When using Corian® in exterior applications, it is especially important to mount the material on a substrate or sub-frame using a method that allows for the thermal contraction/expansion of the material.

FIXING SYSTEMS SPECIFICATION:

The fixing system usually used to mount DuPont™ Corian® cladding panels is a mechanical fixing system based on an aluminium grid system consisting of vertical profiles 'T' or 'L' shape, mounted on aluminium squares connected to the substrate.

The cladding panels are hung on the horizontal profile 'C' shape by the brackets (or clamps) with reverse 'C' shape, that are attached to the back of the panel with a specific undercut anchor from Keil company, making fixings invisible. Cavity between panel and the rear wall is partially filled with insulation, protected by DuPont™ Tyvek® membrane, so the air can ventilate behind the profiles. The whole fixing system allows Corian® sheets to dilatate in all directions.

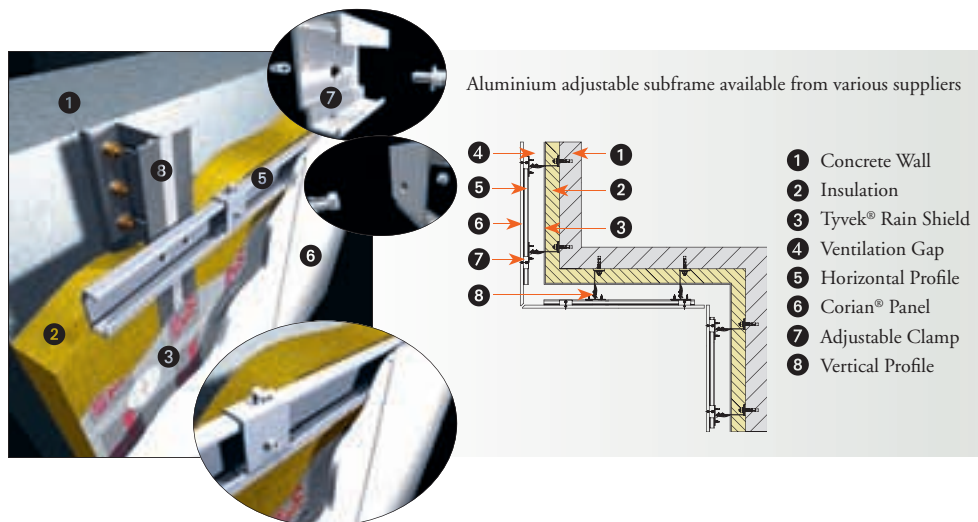
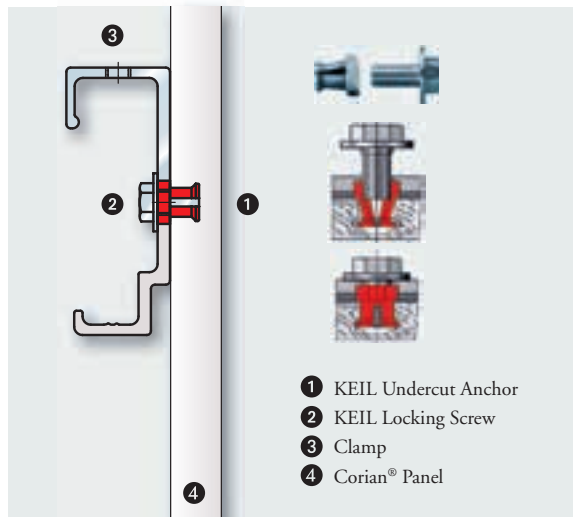

RECOMMENDED COLOURS OF DUPONT™ CORIAN® FOR EXTERNAL CLADDING

DuPont offers a selection of colours recommended for exterior cladding applications. These colours are expected to meet architectural guidelines for a colour change of less than or equal to 5 units (ΔE) in 10 years based on tests according to ASTM standards (ASTM G7 & ASTM G155).

Designer White	Glacier White	Cameo White	Vanilla
Bisque	Bone	Clay	Ethereal Azure (2012)
Elegant Gray (2012)	Light Ash (2012)	Private Gray (2012)	Silver Gray (2012)
Distinct Tan (2012)	Glacier Ice	Lime Ice	Mint Ice

FLOORING

DuPont™ Corian® can be used as a flooring material in low traffic areas where high abrasion resistance is not required. Corian® is warm to the touch, making it ideal for bathroom floors on which people walk barefooted. This application allows for the possibility of material and colour co-ordination between the floor, walls and vanity tops. The following characteristics make Corian® the perfect material for this specific application: inconspicuous joints to give the impression of a continuous floor with the option of a coved connection between the floor and walls, decorative inlays in contrasting colours, easy maintenance to remove superficial scratches and surface damage.

Corian® can be installed on any flat surface suitable for tiling including dry concrete, moisture-resistant plywood, water-resistant gypsum board, vinyl or even existing tiled floors. If the substrate is not solid and uniform, loose parts must be removed and gaps filled with broken tile and tile adhesive. All surfaces must be steady, horizontal, perfectly flat and clean. Any residue such as dust, oil or wax must be eliminated before starting the installation process. An epoxy adhesive can be used to attach Corian® to the substrate to allow for expansion. To maximise slip resistance, particularly in wet areas, it is recommended to roughen the surface by sanding with 120+ μm grit paper. When fabricating a floor in Corian®, it is important to avoid trapping uncured adhesive, which could weaken the flooring system.

Installation & Maintenance

INSTALLATION

It is a condition of the 10-Year Limited Installed Warranty Program that a Quality Network member must carry out the installation. This is due to the fact that the quality of the finished DuPont™ Corian® surface is strongly dependent on proper installation. Large Corian® countertops are usually fabricated in pieces in the workshop and joined on site, which facilitates transportation and reduces the risk of breakage.

MAINTENANCE

Daily Care

Corian® is easy to clean. Its fresh, hygienic appearance can be maintained by wiping up spills, grease and stains with a damp cloth and soapy water, using ammonia based “hard-surface” cleaner or a mild cream abrasive cleanser or common household degreaser, and then wiping dry with a soft cloth. Sinks should be cleaned thoroughly to remove greasy deposits and stains. Once or twice a week, they should be partially filled with warm water and 1-2 teaspoons of liquid bleach and then left to sit for a few hours or overnight. To prevent lime scale build-up from hard water, counters should be damp-wiped and then dried. In difficult areas, such as around drains or taps, a household lime scale remover can be used occasionally.

Abuse

Corian® is inherently “renewable” because it is solid and homogeneous all the way through. Most damage, including severe impact, heat or chemical damage, can usually be repaired on-site and the original smooth, hygienic solid surface restored. For professional sanding of a Corian® work surface, contact your local supplier, who should be able to refer you to a local Corian® Quality Network Fabricator or Service Centre. Corian® Quality Network Service Centres are approved by DuPont to carry out expert repair work. They can also handle installation work and offer maintenance contracts to commercial customers who wish to keep their Corian® installations in prime condition.

RECOMMENDATIONS

Heat

- Always use a heat protection pad, trivet (with rubber feet) or protective sink mat for hot cookware, or leave cookware to cool on the hob first. Never place hot pans, particularly cast iron pans, directly onto a DuPont™ Corian® top or in a sink. Excessive heat can damage any surface.
- Pouring boiling liquids directly into sinks without turning on the cold tap may damage your Corian® surface.
- Always use the correct-sized pan on the burner and place it centrally since an overhanging pan may scorch the adjacent surfaces.

Scratches

Like all materials, Corian® will develop slight abrasion marks as a result of normal daily use. Please note the following:

- Never cut or chop on Corian® as this will score the work surface. Use a cutting board instead.
- Dark, heavily pigmented colours will show scratches, dust and ordinary wear and tear more readily than lighter, textured colours (for more details, refer to the separate colour chart printed on the interior of the book cover or to a colour brochure).

Chemical Spills

Accidental spills of strong chemicals (e.g. paint stripper, brush cleaners, metal cleaners, oven cleaners, cleaners containing methylene chloride, acid drain cleaners, acetone-based nail polish removers, etc.) should be flushed promptly with plenty of soapy water to avoid damaging worktops. For nail varnish spills, non-acetone based remover can be used and then flushed with water. Undetected or prolonged exposure to chemicals may damage the surface. Please refer to the Corian® spec datasheet with your local supplier or visit www.corian.com for additional details regarding chemical exposure, clean up methods and general maintenance. In case of exposure outside the specifications listed in our spec data, the 10-Year Limited Product Warranty will be void and handled as a case of abuse.

Contacts

EUROPE

HEADQUARTERS

DUPONT DE NEMOURS
INTERNATIONAL SÀRL.
2, CHEMIN DU PAVILLON/P.O. BOX 50
CH-1218 LE GRAND-SACONNEX
GENEVA
SWITZERLAND
TEL: +41 22 71 75 111
FAX: +41 22 71 75 109

AUSTRIA

DUPONT DE NEMOURS
(DEUTSCHLAND) GMBH
HUGENOTTENALLEE 173-175
D- 63263 NEU-ISENBURG
FREE TELEPHONE NUMBER:
0800 29 58 33
FAX: +49 61 02 18 25 24

BENELUX

DUPONT DE NEMOURS (BELGIUM) BVBA
ANTOON SPINOYSTRAT 6
B-2800 MECHELEN
BELGIUM
TEL: +32 15 47 32 99
FAX: +32 24 03 53 42
FREE TELEPHONE NUMBER
(BELGIUM ONLY): 0800 96 666
FREE TELEPHONE NUMBER
(LUXEMBOURG ONLY): 0800 23 079
FREE TELEPHONE NUMBER
(NETHERLANDS ONLY): 0800 02 23 500

DENMARK

DUPONT DANMARK APS
SKØJTEVEJ 26
DK-2770 KASTRUP
DENMARK
TEL: +45 32 47 98 00
FAX: +45 77 31 15 79

FINLAND

NOMART OY
MERIKASARMINKATU 6
00160 HELSINKI
FINLAND
TEL: +358 96 61 477
FAX: +358 96 63 728

FRANCE

DU PONT DE NEMOURS
(FRANCE) S.A.S.
DÉFENSE PLAZA
23/25 RUE DELARIVIÈRE LEFOULLON
DÉFENSE 9
92800 PUTEAUX
FRANCE
TEL: +33 1 41 97 44 00
FAX: +33 1 41 97 44 11
FREE TELEPHONE NUMBER:
0800 91 72 72

GERMANY

DUPONT DE NEMOURS
(DEUTSCHLAND) GMBH
HUGENOTTENALLEE 173-175
D- 63263 NEU-ISENBURG
FREE TELEPHONE NUMBER:
0800 18 100 18
FAX: +49 6102 18 2524

GREECE

LEADING PRODUCTS S.A
AUTHORIZED DISTRIBUTOR OF
DUPONT™ SURFACES
1901 INDUSTRIAL AREA AVLONA
BOX OFFICE 45 AVLONA ATTIKIS
GREECE
TEL: +30 22 95 04 40 20
FAX: +30 22 95 04 40 25

ICELAND

DUPONT SURFACES
BOX 84
425 02 HISINGS KÄRRA
SWEDEN
TEL: +46 31 57 68 00
FAX: +46 31 57 34 53

ITALY

DU PONT DE NEMOURS ITALIANA S.R.L.
BUILDING INNOVATIONS
VIA PIERO GOBETTI 2/C
20063 CERNUSCO S/NAVIGLIO MI
ITALY
TEL: +39 02 92 629 349
FAX: +39 02 360 493 61
FREE TELEPHONE NUMBER:
800 876 750

SHOWROOM:

DUPONT™ CORIAN® DESIGN STUDIO
MILANO
VIA MELZO 7
20129 MILANO
TEL: +39 02 95 42 42 42
WEBSITE: WWW.CORIAN-DESIGN.IT

NORWAY

DUPONT NORGE AS
POSTBOKS 6154
NO 0602 OSLO
NORWAY
GRENSEVEIEN 91
TEL: +47 22 08 79 00
FAX: +47 22 08 79 29

PORTUGAL

MATERFUT (DISTRIBUIDOR OFICIAL)
ESTRADA DA RAINHA, 807
4410-030 SERZEDO
VILA NOVA DE GAIA
PORTUGAL
TEL: +351 22 75 36 900
FAX: +351 22 75 36 909

SPAIN

DU PONT IBÉRICA, S.L.
EDIFICIO L'ILLA
AVENIDA DIAGONAL 561
ES-08029 BARCELONA
SPAIN
TEL: +34 93 22 76 132
FAX: +34 93 22 76 200
FREE TELEPHONE NUMBER:
901 12 00 89

SWEDEN

DUPONT SVERIGE AB
BOX 84
425 02 HISINGS KÄRRA
SWEDEN
TEL: +46 31 57 68 00
FAX: +46 31 57 34 53

SWITZERLAND

DUPONT DE NEMOURS
INTERNATIONAL SÀRL.
2, CHEMIN DU PAVILLON/P.O. BOX 50
CH-1218 LE GRAND-SACONNEX
GENEVA
FREE TELEPHONE NUMBER:
0800 55 46 14
FAX: +41 52 34 36 424

UNITED KINGDOM AND IRELAND

MCD MARKETING LIMITED
10 QUARRY COURT
PITSTONE GREEN BUSINESS PARK
PITSTONE, NR. TRING
BUCKS. LU7 9GW
UK
TEL: +44 12 96 66 35 55
FAX: +44 12 96 66 35 99
FREE TELEPHONE NUMBER
(UNITED KINGDOM ONLY):
0800 96 21 16
FREE TELEPHONE NUMBER
(IRELAND ONLY): 1800 55 32 52

CENTRAL AND EASTERN EUROPE

HEADQUARTERS

DUPONT CZ S.R.O.
PEKARSKA 14/628
CZ-155 00 PRAGUE 5
CZECH REPUBLIC
TEL: +420 25 74 14 213
FAX: +420 25 74 14 150

BOSNIA & HERZEGOVINA

DUPONT SRB D.O.O.
OMLADINSKIH BRIGADA 88
11070 NEW BELGRADE
SERBIA
TEL: +381 11 20 90 581
FAX: +381 11 20 90 598

BULGARIA

DUPONT DE NEMOURS
INTERNATIONAL SÀRL.
TRADE REPRESENTATION IN BULGARIA
1766 SOFIA, MLADOST 4
BUSINESS PARK SOFIA
BUILD.1A, FLOOR 1
BULGARIA
TEL: +359 24 89 91 55
FAX: +359 24 89 91 56

CZECH REPUBLIC

DUPONT CZ S.R.O.
PEKARSKA 14/628
CZ-155 00 PRAGUE 5
CZECH REPUBLIC
TEL: +420 25 74 14 213
FAX: +420 25 74 14 150

HUNGARY

DUPONT MAGYARORSZÁG KFT.
2040 BUDAÖRS
NEUMANN JÁNOS U.1
MAGYARORSZÁG
TEL: +36 23 50 94 01
FAX: +36 23 50 94 32
ZÖLDSZÁM: +36 80 20 49 75

KAZAKHSTAN

DUPONT DE NEMOURS (BELGIUM) BVBA
ANTOON SPINOYSTRAT 6
B-2800 MECHELEN
BELGIUM
TEL: +32 15 47 32 73
FAX: +32 24 03 53 42

MONTENEGRO

DUPONT SRB D.O.O.
OMLADINSKIH BRIGADA 88
11070 NEW BELGRADE
SERBIA
TEL: +381 11 20 90 581
FAX: +381 11 20 90 598

POLAND

DUPONT POLAND SP. Z O.O.
UL. POSTĘPU 17B
02-676 WARSZAWA
POLAND
TEL: +48 22 320 09 00
FAX: +48 22 320 09 01

ROMANIA

DUPONT ROMANIA SRL
SOSEAU BUCURESTI PLOIESTI 42-44
BANEASA BUSINESS
& TECHNOLOGY PARK
BUILDING B, 2ND FLOOR
1, BUCHAREST
ROMANIA
TEL: +40 62 04 100
FAX: +40 316204101

RUSSIA

DUPONT RUSSIA
KRYLATSKAYA STR. 17 BL. 3
MOSCOW
RUSSIA, 121614
TEL: +7 495 79 72 200
FAX: +7 495 79 72 201

SERBIA

DUPONT SRB D.O.O.
OMLADINSKIH BRIGADA 88
11070 NEW BELGRADE
SERBIA
TEL: +381 11 20 90 581
FAX: +381 11 20 90 598

SLOVAKIA

DUPONT CZ S.R.O.
PEKARSKA 14/628
CZ-155 00 PRAGUE 5
CZECH REPUBLIC
TEL: +420 25 74 14 213
FAX: +420 25 74 14 150

SLOVENIA AND CROATIA

DUPONT DE NEMOURS
INTERNATIONAL SÀRL.
PODRUŽNICA V SLOVENIJI
CESTA V MESTNI LOG 88A
1000 LJUBLJANA, SLOVENIA
TEL: +386 41 37 00 31

UKRAINE

“DUPONT UKRAINE” LLC
“PODIL PLAZA” BUSINESS CENTER
30A, SPASKA STREET
KYIV, 04070
UKRAINE
TEL: +380 44 49 52 670
FAX: +380 44 49 52 671

MIDDLE EAST AND AFRICA

REGIONAL OFFICE FOR MEA

DUPONT PRODUCTS S.A.
P.O. BOX 33718
DUBAI
UNITED ARAB EMIRATES
TEL: +971 43 21 15 30
FAX: +971 43 21 15 33

EGYPT

DUPONT PRODUCTS S.A.
106 TOWN CENTER
1ST SECTOR, OFF STREET 90
2ND FLOOR, NEW CAIRO - CAIRO
EGYPT
TEL: +202 29 20 11 12/3
FAX: +2017 51 48 885

PAKISTAN

DUPONT PAKISTAN
2ND FLOOR, BAHARIA COMPLEX 1
M.T.KHAN ROAD
KARACHI 74000
PAKISTAN
TEL: +92 21 56 11 110

SAUDI ARABIA

DUPONT PRODUCTS SA
EASTERN CEMENT TOWER
4TH FLOOR-405
ALKHOBAR 31952
SAUDI ARABIA
TEL: +966 (0) 50 46 82 565

SOUTH AFRICA

DUPONT DE NEMOURS SA
BLOCK B, LEVEL 1
34 WHITELY RD
MELROSE ARCH
SOUTH AFRICA, 2196
TEL: +27 (0)11 21 88 618
FAX: +27 (0)82 79 79 078

TURKEY

DUPONT TURKEY
BUYUKDERE CAD. NO:122 OZSEZEN IS
MERKEZI
A BLOK KAT:1-3, 34394
ESEENTEPE
ISTANBUL
TURKEY
TEL: +90 21 23 40 04 00
FAX: +90 21 23 40 04 20

NORTH AMERICA

UNITED STATES OF AMERICA

DUPONT SURFACES
CHESTNUT RUN PLAZA 720-GS29
974 CENTRE ROAD
P.O. BOX 2915
WILMINGTON, DE 19805
TEL: +1 800 436-6072
FAX: +1 302 355-3261

LATIN AMERICA

ARGENTINA

DUPONT ARGENTINA S.A.
ING. BUTTY 240, PISO 10
1001 BUENOS AIRES
ARGENTINA
TEL: +5411 40 21 47 00
FAX: +5411 40 21 48 00

BRASIL

DUPONT BRASIL S.A.
AL. ITAPECURU 506 ALPHAVILLE
BARUERI - SP - CEP 06454-080
BRASIL
FREE TELEPHONE NUMBER: 0800 171715
TEL: +5511 41 66 84 12
FAX: +5511 41 66 87 61

COLOMBIA

DUPONT COLOMBIA S.A.
CALLE 113 # 7-21 TORRE A PISO 14
BOGOTÁ
COLOMBIA
TEL: +571 62 92 202
FAX: +571 62 92 428

MEXICO

DUPONT S.A. DE C.V.
HOMERO 206 COL
CHAPULTEPEC MORALES
DELEGACIÓN MIGUEL HIDALGO
11570 DF MEXICO CITY
MEXICO
TEL: +525 72 21 223
FAX: +525 72 21 369

ASIA PACIFIC

AUSTRALIA

DUPONT (AUSTRALIA) LTD
HEAD OFFICE
7 EDEN PARK DRIVE
MACQUARIE PARK NSW 2113
SYDNEY
AUSTRALIA
TEL: +61 2 99 23 61 11
FAX: +61 2 99 23 60 11
FREE TELEPHONE NUMBER:
1 800 252 997

CAMBODIA

REPRESENTATIVE OFFICE OF
"DU PONT (THAILAND) LIMITED"
REGENCY SQUARE B GROUND FLOOR
SUITE NO. 20-21, 296 MAO TSE
TOUNG BLVD (ST. 245)
SANGKAT TOMNOUPTOUK
KHAN CHAMKAMON
PHNOM PENH, CAMBODIA
TEL: +855 23 42 44 97/98
FAX: +855 23 21 60 78

CHINA

DUPONT CHINA HOLDING CO.LTD.
BEIJING OFFICE
UNIT 1101
CHINA WORLD TOWER 2
NO.1 JIANGUOMEN WAI AVENUE
BEIJING
100004, CHINA
TEL: +86 10 650 580 00
EXT.1033/3018
FAX: +86 10 650 580 08

DUPONT CHINA HOLDING CO.LTD.
SHANGHAI OFFICE
BUILDING 11
399 KEYUAN ROAD
ZHANGJIANG HI-TECH PARK
PUDONG NEW
DISTRICT, SHANGHAI 201203, CHINA
TEL: +86 21 386 228 88
FAX: +86 21 386 225 89

HONGKONG

DUPONT CHINA LTD.
26/F, TOWER 6
THE GATEWAY
9 CANTON ROAD
TSIM SHA TSUI
HONG KONG
TEL: +852 27 34 53 53
FAX: +852 27 21 98 97

INDIA

E.I.DUPONT INDIA P.LTD
DLF CYBER GREEN
TOWER- C, 7 TH FLOOR
DLF PHASE - III, SECTOR - 25A
GURGAON, 122 002
INDIA
TEL: +124 409 18 18/409 28 28
FAX: +124 254 08 89/90/91

INDONESIA

PT.DUPONT INDONESIA
BELTWAY OFFICE PARK
GEDUNG A, 5TH FL
JL. AMPERA RAYA NO. 9-10
JAKARTA 12550
TEL: +62 21 78 22 555
FAX: +62 21 78 22 565

JAPAN

DUPONT-MRC CO. LTD.
NO.45 KOWA BLDG.
1-15-9, MINAMI AOYAMA
MINATO-KU
107-0062 TOKYO
JAPAN
TEL: +81 3 54 10 85 51
FAX: +81 3 54 10 85 01

MALAYSIA

DUPONT MALAYSIA SDN BHD
6 FLOOR, BANGUNAN SAMUDRA
1, JALAN KONTRAKTOR U1/14
HICOM-GLENMARIE INDUSTRIAL PARK
40150 SHAH ALAM
SELANGOR
MALAYSIA
TEL: +603 55 69 30 06 EXT 501
FAX: +603 55 69 30 01

PHILIPPINE

DUPONT FAR EAST INC.
8F, ISQUARE BULDG.
#15 MERALCO AVE.
1605, PASIG CITY
PHILIPPINE

REPUBLIC OF KOREA

DUPONT (KOREA) LTD.
726 YEOKSAM-DONG
ASIA TOWER
4/5TH FLOOR
KANGNAM-KU
SEOUL, 135-082
SOUTH KOREA
TEL: +82 2 22 22 52 00
FAX: +82 2 22 22 54 70

SINGAPORE

DUPONT COMPANY (SINGAPORE)
PTE. LTD.
1 HARBOURFRONT PLACE #11-01
HARBOURFRONT TOWER ONE
098633 SINGAPORE
TEL: +65 65 86 36 88
FAX: +65 62 72 74 94

TAIWAN

DU PONT TAIWAN LTD.
13/F, HUNG KUO BUILDING
167 TUN HWA NORTH ROAD
TAIPEI 10590
TAIWAN
TEL: +886 2 27 19 19 99
FAX: +886 2 27 19 08 52

THAILAND

DU PONT (THAILAND) LTD.
6-7TH FLOOR, M. THAI TOWER
ALL SEASONS PLACE
87 WIRELESS ROAD
LUMPINI, PHATUMWAN
10330 BANGKOK
THAILAND
TEL: +66 2 65 94 000
FAX: +66 2 65 94 001/3

VIETNAM

DUPONT VIET NAM LTD
12TH FLOOR, CENTRAL PLAZA BUILDING
17 LE DUAN BLVD., DISTRICT 1
HCM CITY
VIETNAM
TEL: +84 38 24 31 92
FAX: +84 38 24 31 91

DUPONT VIET NAM LTD
SOFITEL PLAZA HANOI, UNIT 9, 3RD
FLOOR, NO. 1
THANH NIEN ROAD, BA DINH DISTRICT
HANOI
VIETNAM
TEL: +84 4 37 15 23 53/4 /5/6/7
FAX: +84 4 37 15 23 58

QUALITY NETWORK

In order to transform DuPont™ Corian® into designer creations, DuPont has developed a Quality Network of people dedicated to delivering the very best standards of installation and service.

Their primary goal is to ensure that customers are highly satisfied with their DuPont™ Corian® installations. The members of the DuPont™ Corian® Quality Network are:

- Authorised DuPont™ Corian® fabricators/installers
- DuPont™ Corian® Service Centres
- Warranty Co-ordinators

All members have been trained by DuPont in the fabrication, installation, repair and maintenance of DuPont™ Corian® solid surfaces. Quality Network members are also responsible for applying and fulfilling the 10-Year Limited Installed Warranty Program.

SERVICE CENTRES

Service Centres are independent companies operating in a network under an agreement with DuPont. They install DuPont™ Corian®, handle warranty claims quickly and efficiently, and implement and execute the DuPont™ Corian® Care and Maintenance Program at pre-determined rates. Their main objective is to provide the highest possible level of customer satisfaction.

WARRANTY

DuPont offers two levels of warranty protection for DuPont™ Corian®: product and installed. The Product Warranty is standard for all DuPont™ Corian® products and ensures that they will be free of manufacturing defects for a period of 10 years after purchase.

A higher level of coverage, the Limited Installed Warranty, is only available when fabrication and installation is carried out by a DuPont™ Corian® Quality Network fabricator.

This Limited Installed Warranty expands the Product Warranty and also ensures that the fabrication and installation of the finished product will be free of defects.

For further information, please contact your local DuPont™ Corian® office.

This information corresponds to our current knowledge on the subject. It is offered solely to provide suggestions for your own experimentation. It is not intended, however, as a substitute for any testing you may need to conduct to determine for yourself the suitability of our products for your particular purposes.

This information may be subject to revision as new knowledge and experience becomes available, since we cannot anticipate all variations in the actual end-use of Corian®.

Nothing in this publication is to be considered as a license under which to operate or a recommendation to infringe any patent right.

GENERAL DISCLAIMER

Colour reference values and printed colours are not necessarily indicative of actual DuPont™ Corian® colour. Each colour represented although close to reality, should be considered purely indicative due to print limitations. Colour appearance will vary based on lighting conditions and angle of view. DuPont™ Corian® cannot be held responsible if the end product has a slight aesthetical difference.

LEGAL NOTICE

INTELLECTUAL PROPERTY

All the decorations, solutions, systems, products, installations and designs shown in the images included in this publication are intellectual property of their respective owners. Copying the decorations, solutions, systems, products, installations and designs shown in these images will result in the violation of the intellectual property of their respective owners. Persons infringing these intellectual property rights will be held accountable in accordance with applicable legislation.

PROPERTY AND USE OF IMAGES

The images used in this publication are property of E. I. du Pont de Nemours and Company or its affiliated companies or, alternatively, are property of companies, architects, designers, organization or other entities or individuals. No copy of images included in this publication is authorized. The unauthorized use of these images constitutes a violation of the laws on intellectual property and Copyrights, owners. Persons infringing these rights will be held accountable in accordance with applicable legislation.

INSTALLATIONS, PRODUCTS AND DESIGNS SHOWN IN THIS PUBLICATION

The installations, products and designs made with/in DuPont™ Corian® which are shown in the images included in this publication are either products/creations of DuPont or are products/creations of other companies, architects, designers, individuals or organizations. All these products/creations are shown with the goal of communicating to the readers of this publication the design and fabrication versatility and the wide application possibilities of DuPont™ Corian®.

DuPont does not accept any responsibility concerning the commercial availability, the properties and the performance of products/creations made by other companies, architects, designers, individuals or organizations. Individuals or organizations interested in knowing more about the products/creations of DuPont should contact DuPont; individuals or organizations interested in knowing more about the products/creations of other companies, architects, designers, individuals or organizations should contact these other parties (see photo-credits).

On the cover: Palais des Congrès, Ivoire Hotel, Abidjan, Ivory Coast;
project by Pierre Fakhoury; photo DuPont™ Corian®

www.corian.com

The DuPont Oval, DuPont™, The miracles of science™ and Corian® are registered trademarks or trademarks of E.I. du Pont de Nemours and Company or its affiliates. Only DuPont produces Corian®. Copyright © 2012 DuPont. All rights reserved. Other logos, registered trademarks and trademarks are property of their respective owners.



corian.



Printed in Italy with soy-based inks

www.corian.com

The DuPont Oval, DuPont™, The miracles of science™ and Corian® are registered trademarks or trademarks of E.I. du Pont de Nemours and Company or its affiliates. Only DuPont produces Corian®. Copyright © 2012 DuPont. All rights reserved. Other logos, registered trademarks and trademarks are property of their respective owners.

DPS-1820-12



The miracles of science™